



# SLIM IMAGEART MEDIA FRAME

The **SLIM IMAGEART MEDIA FRAME** is an easy to use Snap Frame System that accommodates medium size graphics, promotional signage, and backlit materials in nearly a 1" thick frame

With our **SLIM IMAGEART MEDIA FRAME**, medium sized media graphics (up to 120" x 60") are typically printed on a DURATRANS film and backlit by evenly distributed light for beautiful displays that promote any artwork in a thin profile

The **SLIM IMAGEART MEDIA FRAME** may be used for a variety of applications that include:



Branding



Residential



Restaurants



Custom Fixtures



Hospitality



Retail



Healthcare



Gallery Displays



Signage



Custom Art Displays



Bar



Commercial Interior

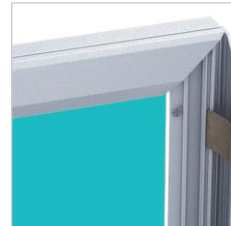

SLIM IMAGEART MEDIA FRAME FRONT CORNER

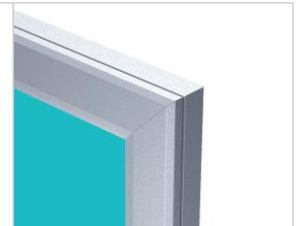

CLOSED SLIM IMAGEART MEDIA FRAME CORNER DETAIL



SLIM IMAGEART MEDIA FRAME BACK CORNER



SLIM IMAGEART MEDIA FRAME WITH MOUNTING BRACKET

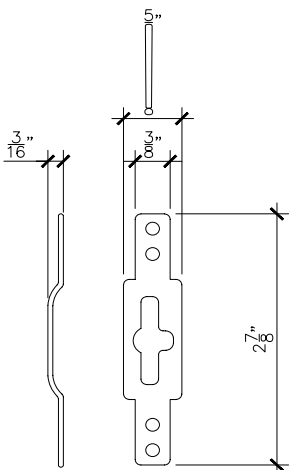

KEYHOLE MOUNTING BRACKET

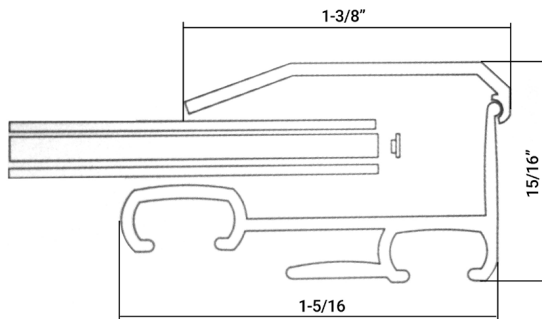

SLIM IMAGEART MEDIA FRAME CROSS SECTION DETAIL



# DIMENSIONS

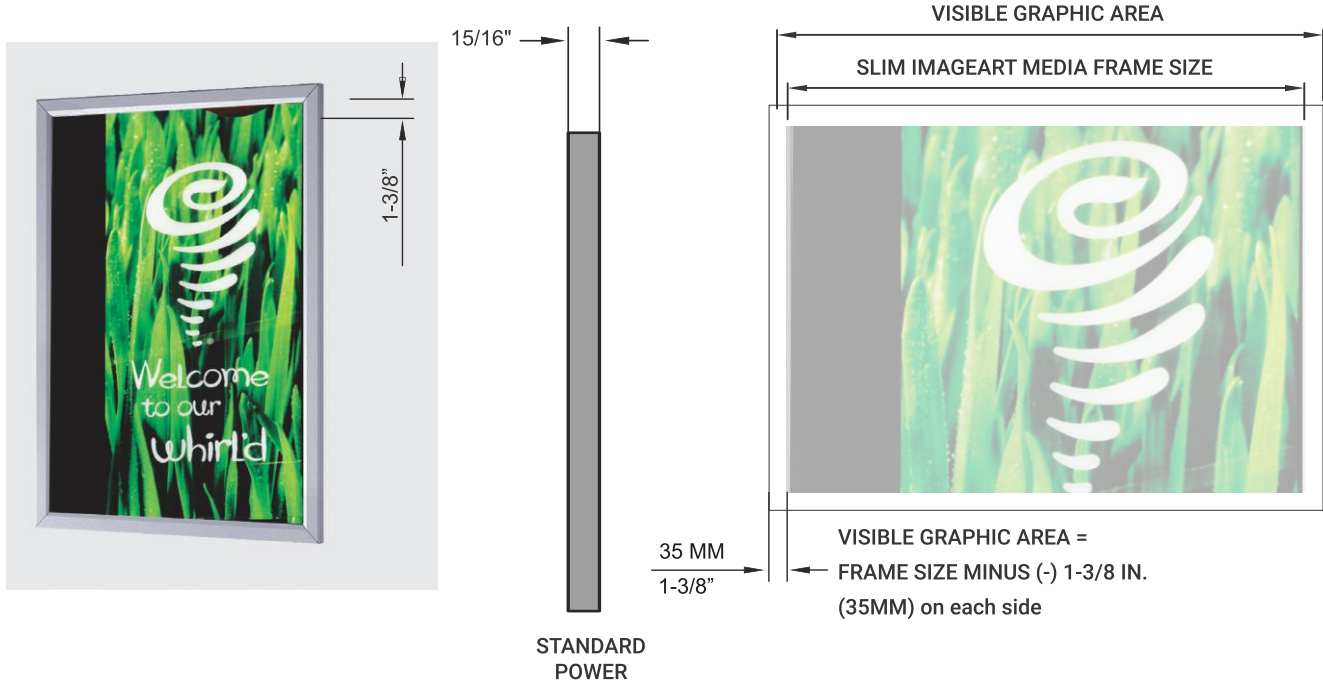

# APPLICATIONS

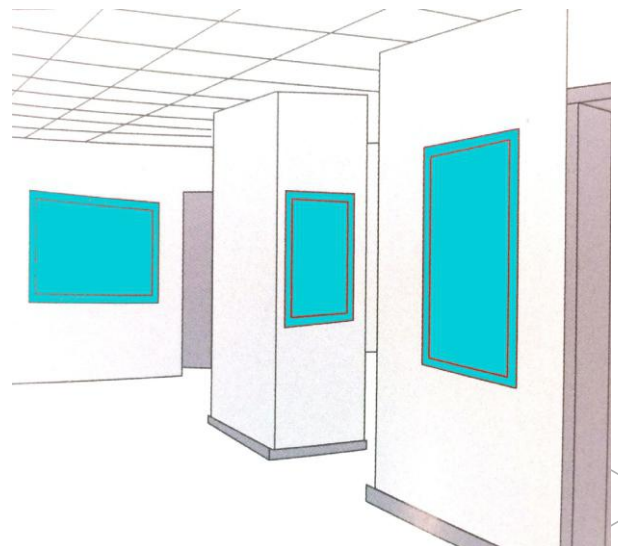

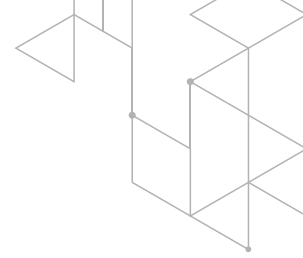

# General Specifications

### LIGHT WEB TECHNOLOGY™ :

3D etched patterns to evenly distribute light throughout the panel. Patterns available are GRID, DOT and MICRODOT™

### THICKNESS:

15/16"

### MAXIMUM SIZE AND PROPORTIONS:

120" x 60"

### MINIMUM SIZE:

6" x 6"

### POWER OPTIONS:

24VDC Standard and 24VDC High Power

### DRIVER INPUT VOLTAGE :

100V TO 480V

### LONG LIFE :

Over 50,000 hours = Nearly 12 years based on 12 hours a day. Once installed, the LightPanel System is virtually maintenance free.

### WATTAGE :

4.3 W/Ft . -24V Standard Power (Optional: 12V)  
5 W/ Ft. - 24V - High Power  
\*ask eos specialist for information on RGB, RGBW and Color Tuning options.

### DIMMABLE :

The system is dimmable to <10% when matched with Dimmable Power Supplies

### LEDs :

ANSI Binned LEDs from Tier 1 Suppliers  
LED CRI > 80, 95+ Premium option  
LED CRT - 1800K - 7500K, RGBW, RGB, Tunable, UV

### WIRE GAUGE:

20GA Wiring for White and Color Tuning Panels, 24GA for Color

### SERVICE AND INSTALLATION :

The Slim ImageArt MediaFrame comes with standard keyhole surface mounts, optional suspension mounts are also available.

### IP RATNG:

Indoor Rated

# Optional Specifications



### COMPATIBLE POWER SUPPLIES :

- 0-10V dimming • DMX/DALI
- Electronic low voltage (ELV)
- RF Dimmable Plug In
- Inline Dimmable Plug-In



### OUTPUT OPTIONS:

24V Standard Power or 24V High Power available. 12V available upon request



### COLOR TEMPERATURES :

- 1800K • **2400K** • **2700K** • **3000K**
- 3500K • **4000K** • 5000K
- **6000K** • **6500K** • 7500K
- UV (Ultraviolet) • RGB, RGBW and Color Tuning options available

\*formerly 5300K

**Bolded** colors are commonly available in stock.



### APPROVALS AND CERTIFICATIONS:

The System is UL listed for Architectural applications and UL recognized for signage. All power supplies are UL / ETL listed.



<https://eoslight.com/user-guide/>



DOWNLOAD OUR USER GUIDE FOR WIRING & INSTALLATION INSTRUCTIONS



# Product Specification Ordering Form

NAME: \_\_\_\_\_ PROJECT NAME: \_\_\_\_\_ ADDRESS: \_\_\_\_\_

PHONE: \_\_\_\_\_ PROJECT LOCATION: \_\_\_\_\_ CITY: \_\_\_\_\_

EMAIL: \_\_\_\_\_ ANTICIPATED DELIVERY DATE: \_\_\_\_\_ ZIP CODE: \_\_\_\_\_

COMPANY NAME: \_\_\_\_\_ PROJECT SPECIFIER: \_\_\_\_\_ RUSH PROJECT:  Yes  No

| QTY | FIXTURE TYPE | VOLTAGE | DIMENSIONS (INCHES)<br>TOP SIDE |    | LED SIDES | COLOR TEMP | LED POWER | CORD LENGTH | CORD LOCATION | CORD COLOR | POWER SUPPLY |
|-----|--------------|---------|---------------------------------|----|-----------|------------|-----------|-------------|---------------|------------|--------------|
| 5   | SI           | 24V     | 48                              | 50 | 4SL       | 2700       | SP        | CC6         | TL            | BC         | HW           |

## A FIXTURE TYPE

SI - SLIM IMAGEART Media

## B VOLTAGE

24V - 24V (Standard)  
12V - 12V (Optional)

## C DIMENSIONS

(Generated by Client)  
C1- Top Dimension  
C2- Side Dimension

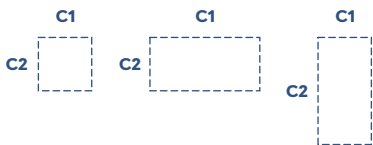

## D LED SIDES

1SL - One Side  
2SL - Two Sides  
3SL - Three Sides  
4SL - Four Sides

Top Dimension

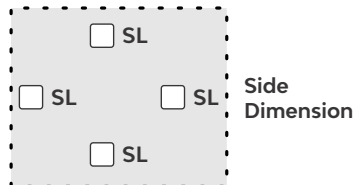

\*Please note, the longest length is typically the LED side when selecting 1SL or 2SL

## E COLOR TEMP

1800 - 1800K    6500 - 6500K  
 2400 - 2400K    7500 - 7500K  
 2700 - 2700K    UV - Ultraviolet  
 3000 - 3000K    RGB - Color Changing  
 3500 - 3500K    RGBW - Color Changing  
 4000 - 4000K    + White (6000K, 4000K,  
 5000 - 5000K    2700K)  
 6000 - 6000K    CT- Color Tuning  
                           (2400K to 6000K)

## F LED POWER

SP- Standard Power    PSP- Premium Standard Power (95+ CRI)  
HP- High Power        PHP- Premium High Power (95+ CRI)

## G POWER CORD LENGTH

SC - Standard 9'  
CC - Custom (16' max) \_\_\_\_\_

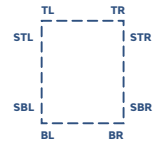

## H POWER CORD EXIT

TL - Top Left Corner    BL - Bottom Left Corner  
TR - Top Right Corner    BR - Bottom Right Corner  
STL - Side Top Left Corner    SBL - Side Bottom Left Corner  
STR - Side Top Right Corner    SBR - Side Bottom Right Corner

## I POWER CORD COLOR

BC - Black    WC - White

## J POWER SUPPLY INFO

010V - 010V Dimmable Hardwire  
ELV - Electronic Low Voltage Dimmable Hardwire  
DMX - DMX /DALI  
PI - Plug In, DC Jack  
DPI - Dimmable Plug in w/ remote  
HW - Non-Dimmable Hardwired



PROJECT NAME:

PROJECT LOCATION:

# Please fill out the form

| ITEM | QTY | A          | B       | C1                     | C2 | D         | E          | F         | G        | H           | I             | J          | K            | L                                      |
|------|-----|------------|---------|------------------------|----|-----------|------------|-----------|----------|-------------|---------------|------------|--------------|--|
|      |     | PANEL TYPE | VOLTAGE | DIMENSIONS<br>TOP SIDE |    | LED SIDES | COLOR TEMP | LED POWER | DIFFUSER | CORD LENGTH | CORD LOCATION | CORD COLOR | POWER SUPPLY | IF CURVED PANEL SPECIFY RADIUS(INCHES) |
| 1    | 5   | SI         | 24V     | 48                     | 50 | 4SL       | 2700       | SP        | DIF      | CC6         | TL            | BC         | 010V         | 20                                     |
|      |     |            |         |                        |    |           |            |           |          |             |               |            |              |  |
|      |     |            |         |                        |    |           |            |           |          |             |               |            |              |  |
|      |     |            |         |                        |    |           |            |           |          |             |               |            |              |  |
|      |     |            |         |                        |    |           |            |           |          |             |               |            |              |  |
|      |     |            |         |                        |    |           |            |           |          |             |               |            |              |  |
|      |     |            |         |                        |    |           |            |           |          |             |               |            |              |  |
|      |     |            |         |                        |    |           |            |           |          |             |               |            |              |  |
|      |     |            |         |                        |    |           |            |           |          |             |               |            |              |  |
|      |     |            |         |                        |    |           |            |           |          |             |               |            |              |  |
|      |     |            |         |                        |    |           |            |           |          |             |               |            |              |  |
|      |     |            |         |                        |    |           |            |           |          |             |               |            |              |  |
|      |     |            |         |                        |    |           |            |           |          |             |               |            |              |  |
|      |     |            |         |                        |    |           |            |           |          |             |               |            |              |  |
|      |     |            |         |                        |    |           |            |           |          |             |               |            |              |  |

**1. What is the Application the panels will be used for?**  
 E.g.: Hospitality, Retail, Signage Etc.

**2. What are the LightPanels backlighting?**  
 E.g.: Stone, Graphic, Glass, Acrylic Etc.

**3. Will the LightPanels be installed adjacent to one another?**  
 Yes  No  
 If Yes, Please Provide Drawing of Panel Layout

**4. Will the LightPanels be powered individually (1:1) or would you like to connect Multiple LightPanels to a single driver?**

**5. Are there any installation details to review?**

**5. Is there an existing Dimming or Lighting Control System?**  
 If so, please provide Representative with information of the Control system (specs, manufacturer, etc.)

**Additional information:**